

The Fountainhead Group Compressed Air Sprayer

Owner's Manual

OMLB-2, OMLP-2, RMLB-2, RMLP-2

If you have any problems with, or have any questions about your sprayer **BEFORE YOU RETURN IT TO THE STORE, CALL OUR TOLL FREE CUSTOMER SERVICE CENTER AT:**

1-800-3 11-9903

WARNING!

The sprayer is operated with liquid under pressure. Failure to observe CAUTION and to follow instructions for operating and cleaning can cause tank, hose and other parts to be weakened and/or rupture under pressure. This can result in SERIOUS INJURY from high pressure discharge of liquids or forcible ejection of parts. **DO NOT USE FLAMMABLE MATERIALS IN THIS SPRAYER.** Material could ignite or explode, causing serious injury. **FOR SAFE USE OF THIS PRODUCT - YOU MUST READ AND FOLLOW ALL INSTRUCTIONS BEFORE USE.** TEST SPRAYER WITH WATER BEFORE USING ANY CHEMICALS.

SAFETY PRECAUTIONS:

1. Read owner's manual completely before operating this sprayer.
2. This sprayer is designed for light duty lawn and garden use only.
3. Always use goggles, gloves and protective clothing when using sprayer.
4. Read and follow all instructions and cautions on label of products used in this sprayer
5. Spray when air is calm to prevent drift of chemical.
6. Do not leave sprayer in the sun when not in use.
7. Never use flammable liquids, caustics, acids or hot water in this tank.
8. Never store chemicals in this tank.
9. Always release pressure when sprayer is not in use and before removing pump from tank.
10. Never stand with face or body over sprayer when pressurizing tank or releasing pressure.
11. Clean and rinse sprayer thoroughly after each use.
12. Never attempt to alter sprayer from original condition.
13. Always use replacement parts from original manufacture r.

HOSE ASSEMBLY INSTRUCTIONS



1. PUSH HOSE COMPLETELY ON.

2. TIGHTEN NUT COMPLETELY.

NEVER USE SPRAYER WITHOUT NUT.

ASSEMBLY INSTRUCTIONS

HOSE ASSEMBLY TO TANK:

IMPORTANT: A hose nut is included in the parts kit. The hose nut is **required** for proper assembly of the sprayer. **Do not attempt to heat, or alter** hose, hose nut, or barb prior to assembly.

1. Slide hose nut over end of hose (observe proper hose nut orientation in above diagram). Push hose completely onto tank barb, as shown in step #1 of above diagram.
2. Slide hose nut along hose and over barb threads. Turn hose nut clockwise to completely tighten over hose, as shown in step #2 of above diagram (do not use tools)

EXTENSION ASSEMBLY TO SHUT-OFF

1. Remove protective cap from end of shut-off assembly.
2. Screw extension onto end of shut-off assembly until firmly attached.
3. Select a nozzle, using NOZZLE SELECTION CHART. Screw selected nozzle onto extension until firmly attached, **making sure #171092 (o-ring) is in place on end of extension.**
4. When using flat fan nozzles, make sure tabs on nozzle tips are fitted into slots on end of extension. Tip can be installed to produce a vertical or horizontal flat fan.

IMPORTANT!

ALWAYS ENSURE PRESSURE IS RELEASED FROM TANK BEFORE FILLING OR SERVICING. Squeeze shut-off handle and hold down until the unit stops spraying. Then, and only then, is safe to remove pump.

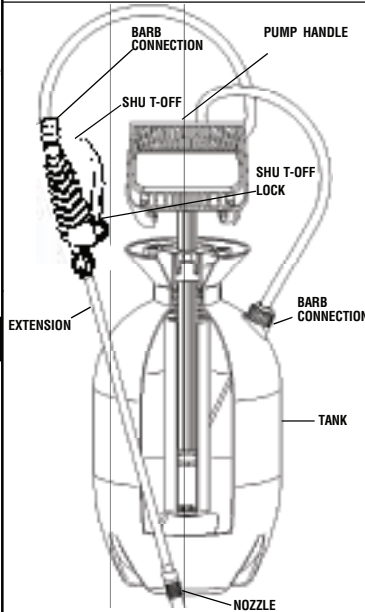

FILTER CLEANING (See SPRAYER MAINTENANCE PAGE 2)

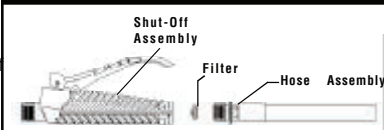

OPERATING INSTRUCTIONS

FILLING

1. Remove pump by turning pump handle counterclockwise.
2. Fill tank to desired level (always refer to chemical manufacturer for proper mixture)
3. Place pump into tank opening and turn handle clockwise to tighten.

PRESSURIZING

1. Make sure shut-off lock is not engaged (if shut-off lock is engaged while pressurizing, the unit will immediately start spraying)
2. Pressurize sprayer by pumping handle in a smooth up and down motion. When desired pressure is achieved, lock handle onto pump.

SPRAYING

1. Point nozzle away from you. Press shut-off button to begin spraying. Release button to stop spraying. When using adjustable nozzle, adjust spray pattern by turning nozzle tip. (Note: Flat fan nozzle is not adjustable).
2. For continuous spraying, squeeze shut-off handle and rotate lock toward the sprayer tip.

FINISHING

1. Direct nozzle away from you and press handle on shut-off until unit stops spraying (this will release pressure in tank).
2. Turn pump handle counterclockwise to remove pump.
3. Empty any remaining liquid according to product disposal directions. Clean sprayer as directed under **CLEANING SPRAYER**.

CLEANING SPRAYER

1. Remove pump as described in **FINISH** section.
2. Fill tank with tap water. Replace pump and turn clockwise to tighten. Agitate tank to rinse chemical off tank wall and pump.
3. Remove pump and empty contents into gravel or bare soil.
4. Refill tank with tap water.
5. Check to be sure pump is free of debris and place pump into tank. Turn handle clockwise to tighten pump.
6. Pressurize tank. Follow all instructions in **PRESSURIZING** section.
7. Point nozzle away from you and spray for approximately 30 seconds to clean hose and shut-off.
8. Release pressure as outlined in **OPERATING** and **FINISH** sections. Empty contents as in step 3.
9. Repeat steps 4 thru 8 until thoroughly cleaned. Note: It is best to keep 2 sprayers: One for herbicides and one for other products, such as fertilizers or insecticides.

SPRAYER MAINTENANCE

1. Pump should be periodically oiled by dropping 10 to 12 drops of light oil down pump rod through opening in cover.
2. If nozzle clogs: remove nozzle assembly, disassemble nozzle and clean openings of any obstructions.
3. Never use any tool to remove pump if there is pressure in spraye
4. If filter clogs: remove and clean filter as shown on page 1 under **FILTER CLEANING**.

SPRAYER STORAGE

1. Sprayer tank should be hung upside down, with pump removed, in a warm, dry location.
2. Do not store or leave any solution in tank after use.
3. Store in a warm dry location out of direct sunlight.
4. **KEEP SPRAYER OUT OF REACH OF CHILDREN.**

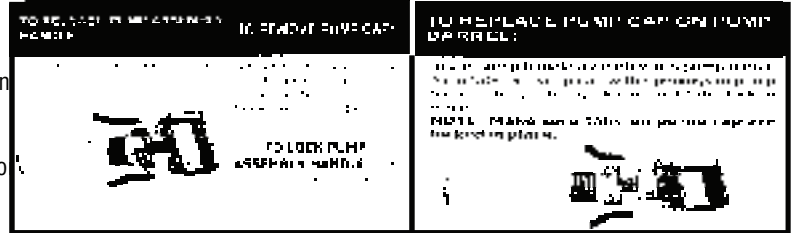

NOZZLE SELECTION CHART

FOAMING NOZZLE

- Spray herbicides, fungicides, and insecticides.
- Apply herbicides, fungicides, and insecticides.
- Apply herbicides, fungicides, and insecticides.
- Apply herbicides, fungicides, and insecticides.



FAN NOZZLE

- Spray herbicides, fungicides, and insecticides.
- Apply herbicides, fungicides, and insecticides.
- Apply herbicides, fungicides, and insecticides.
- Apply herbicides, fungicides, and insecticides.



ADJUSTABLE CONE

- Spray herbicides, fungicides, and insecticides.
- Apply herbicides, fungicides, and insecticides.
- Apply herbicides, fungicides, and insecticides.
- Apply herbicides, fungicides, and insecticides.



PROBLEM	SOLUTION	NOZZLE TYPE			PROBLEM	SOLUTION	NOZZLE TYPE		
		HIGH VOLUME FAN (RED)	ADJUSTABLE CONE	LOW VOLUME FAN (YELLOW)			HIGH VOLUME FAN (RED)	ADJUSTABLE CONE	LOW VOLUME FAN (YELLOW)
Broadleaf Weeds in Lawn	Ortho® Weed-B-Gon® Weed Killer For Lawns, Ortho® Weed-B-Gon® Chickweed, Clover & Oxalis Weed Killer For Lawns			X	Lawn Insects	Ortho® Termite & Carpenter Ant Killer, Ortho® Bug-B-Gon® Multi-Purpose Insect Killer	X		
Grassy Weeds in Lawn	Ortho® Weed-B-Gon® Crabgrass Killer For Lawns			X	Insects on Roses & Ornamental Plants	Ortho® Bug-B-Gon® Multi-Purpose Insect Killer, Ortho® Systemic Insect Control		X	
Brushy Weeds (Such as Poison Oak, Poison Ivy, Kudzu, Wild Blackberry)	Ortho® Brush-B-Gon® Poison Ivy, Poison Oak & Brush Killer		X		Insects on Fruit & Vegetables	Ortho® Bug-B-Gon® Multi-Purpose Insect Killer		X	
Weeds in Non-Planted Areas (Mulch, Gravel, etc.)	Roundup® Weed & Grass Killer	X			Insects and Diseases on Roses & Ornamental Plants	Ortho® Orthenex® Garden Insect & Disease Control		X	
Spot Control of Weeds in Flowerbeds, around Trees & Shrubs	Roundup® Weed & Grass Killer		X		Insects and Disease on Fruit Trees	Ortho® Orthenex® Garden Insect & Disease Control		X	
Disease Control on Vegetables	Ortho® Garden Disease Control		X		Home-Invading Pests in Lawn & Around Perimeter of Home	Ortho® Termite & Carpenter Ant Killer, Ortho® Bug-B-Gon® Multi-Purpose Insect Killer	X		
Disease Control on Fruit Trees	Ortho® Garden Disease Control		X		Dormant Season Spraying for Insect Control on Fruit Trees & Woody Ornamentals	Ortho® Volck® Oil Spray		X	

KEY NO.	PART #	DESCRIPTION	KEY NO.	PART #	DESCRIPTION	KEY NO.	PART #	DESCRIPTION
1	180482	2 Gallon Tank-ML-2, Yellow	14	178024	Extension-Curved-14"-Poly	24	178084	O-Ring
	180507	2 Gallon Tank-ML-2, Natural		180343	Extension-Straight-Brass 14"	25	180011	Lock
2	180292	Funnel		180352	Extension-Curved-Brass 14"	26	180007	Fan Tip Set
3	180294	Pump Barrel	15	178054	Nozzle Cap-Poly	27	180097	High Volume Fan Tip (Red)
4	180296	Pump Cap (2 required)		180340	Nozzle Cap-Brass	28	180168	Low Volume Fan Tip (Yellow)
5	180449	Hose Assembly	16	178052	Nozzle Base	29	178067	Cap Nut
6	180448	Shut-off Assembly	17	178055	Nozzle Assembly-Poly	30	180300	O-Ring, Pump
7	178085	Shut-off Body		180344	Nozzle Assembly-Brass	31	180305	Pump Assembly
8	178090	Shut-off Lever	18	171092	O-Ring	32	180513	Outlet Tube
9	178087	Plunger	19	180298	Pump Handle	33	180364	Nut
10	178088	Shut-off Spring	20	180337	Parts Kit	34	171015	Check Valve
11	178089	Retainer	21	180299	Pump Gasket		180568	Parts List / Instructions
12	178086	Diaphragm	22	180320	Filter (If Equipped)	35	180266	Foaming Nozzle
13	180386	Hose 32"	23	178083	Hose Adapter			

NOTE: MODELS OMLP-2 AND RMLP-2 ARE EQUIPPED WITH POLY EXTENSIONS AND NOZZLES. MODELS OMLB-2 AND RMLB-2 ARE EQUIPPED WITH BRASS EXTENSIONS AND NOZZLES.

To order any parts below, simply state quantity in left hand column, fill in bottom portion, and send to address below

QTY	PART #	DESCRIPTION	COST	TOTAL
	171015	Check Valve	\$1.23	
	178024	Extension-14"	\$3.40	
	180352	Extension-Curved-14" Brass	\$3.40	
	180343	Extension-Straight-14" Brass	\$3.40	
	178055	Nozzle Assembly-Poly	\$3.20	
	180344	Nozzle Assembly-Brass	\$3.20	
	180449	Hose Assembly	\$11.75	
	180448	Shut-off Assembly	\$9.35	
	180007	Fan Tip Set	\$2.80	
	180097	Fan Tip - Red	\$0.60	
	180168	Fan Tip - Yellow	\$0.60	
	180568	Part List	N/C	
	180292	Funnel	\$1.80	

QTY	PART #	DESCRIPTION	COST	TOTAL
	180299	Pump Gasket	\$1.25	
	180300	O-Ring, Pump	\$1.01	
	180305	Pump Assembly	\$10.00	
	180482	2 Gallon Tank, ML-2, Yellow	\$12.00	
	180507	2 Gallon Tank, ML-2, Natural	\$12.00	
	180513	Outlet Tube	\$1.85	
	180364	Nut	\$1.60	
	180337	Parts Kit	\$6.09	
			COST	
			SUBTOTAL	
			8.25% TAX (NY ONLY)	
			SHIPPING & HANDLING	\$3.00
			GRAND TOTAL	

Call 1-800-3 11-9903
with any questions.

COST
SUBTOTAL
8.25% TAX (NY ONLY)
SHIPPING & HANDLING
GRAND TOTAL

180337 PARTS KIT CONTAINS:

PART #	DESCRIPTION	KEY NO.	PART #	DESCRIPTION	KEY NO.	PART #	DESCRIPTION	KEY NO.
178055	Diaphragm	12	180340	Nozzle Cap	15	180299	Pump Gasket	21
178015	Check Valve	34	178055	Nozzle Spring	10	180305	Plunger O-ring	30
178024	O-Ring (3)	18						

ASSEMBLY & REPAIR PARTS Please Refer To The Parts List On Bottom Of Previous Page

CUT ON DOTTED LINE

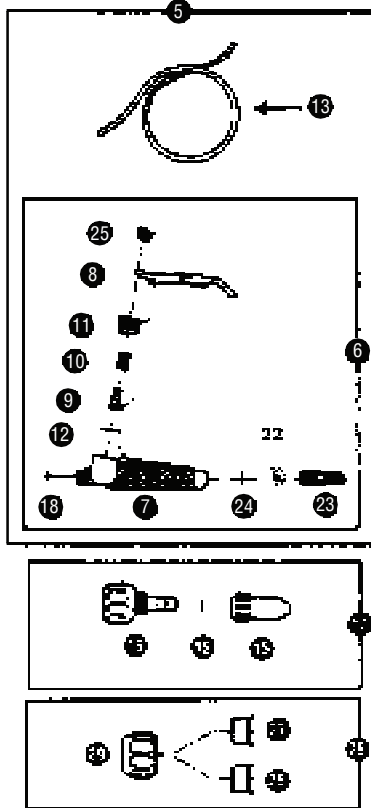
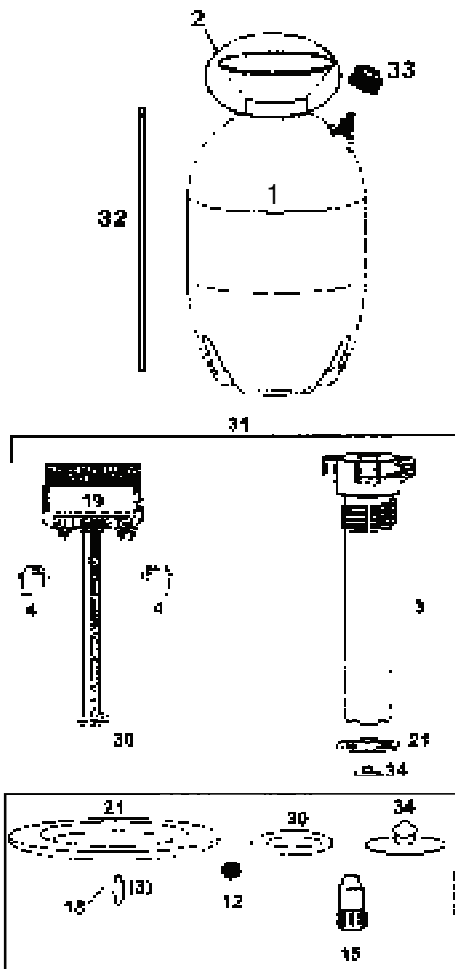

SHUT-OFF ASSEMBLY
How To Assemble and Disassemble
for Maintenance

STEP 1

To remove lever, lift up on rear of lever until lever snaps off pivot pin.



STEP 2

Place lever on plunger, turn counterclockwise and lift out. Turn clockwise to seal.

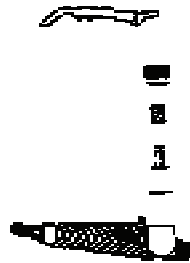

STEP 3 and 4

To replace lever, position forked end of lever under head of plunger and push down until lever snaps on pivot pin.



NOZZLE ASSEMBLY INSTRUCTIONS

Fan Nozzle

Adjustable Nozzle

Framing Nozzle

18

Extension 14

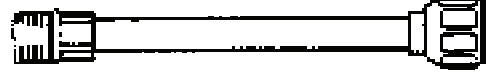
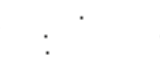

Note: Assemble O-Ring into the end of the extension to prevent leaking

If you have any problems with, or have any questions about your spray BEFORE YOU RETURN IT TO THE STORE, CALL OUR TOLL FREE CUSTOMER SERVICE CENTER AT:

1-800-3 11-9903

NAME

PHONE

ADDRESS

CITY

STATE

ZIP

Method of payment VISA MASTERCARDAcct.
No.

--	--	--	--	--	--	--	--	--	--	--	--	--	--	--	--	--	--	--	--	--

\$10.00 minimum on all credit card orders.

Expiration Date: _____

**PRICES SUBJECT
TO CHANGE**

Send Check payable to:

The Fountainhead Group, Inc.

23 Garden Street • New York Mills, NY 13417 • Telephone: (800) 311-9903 or (315) 736-0037 • FAX: (315) 768-4220
E-mail: Info@TheFGI.com • Web site: www.TheFountainheadGroup.com

CUT

ON DOTTED LINE

LIMITED WARRANTY

We warrant that each product sold by us will be free from defects in material and workmanship for a period of one year from the date of shipment by us for models OMLP-02 and RMLP-02, and 3 years from the date of shipment by us for models OMLB-02 and RMLB-02. We make no other express warranties, and all implied warranties including fitness and merchantability, are limited to one year from the date of shipment by us for models OMLP-02 and RMLP-02, and 3 years from the date of shipment by us for models OMLB-02 and RMLB-02. Within the warranty period, we will repair or replace any part found to be defective upon our examination but will not pay shipping costs or other expenses. To obtain warranty service, write us at The Fountainhead Group, Inc., 23 Garden Street, New York Mills, New York 13417, or call toll free (800) 311-9903 or (315) 736-0037. Merchandise may not be returned without prior permission and must be returned to us prepaid. This warranty service is an exclusive remedy and we are not responsible for any consequential or incidental damages or injury to person or property. This warranty shall not apply to any product which has been subject to misuse, negligence or accident, or been damaged in shipment, or misapplied, or which has been modified or repaired by unauthorized persons. This warranty only applies to products owned by persons purchasing directly from us or from our approved distributors and merchandisers. The right is reserved to incorporate subsequent design or parts changes after publication and without re-issue of descriptive literature or catalogs.

NOTE: Limitations on duration of implied warranty and/or consequential damages may not apply to you if your state does not permit them. This warranty gives you specific legal rights which you may have under state law.

TROUBLE	LOOK FOR	REMEDY
Sprayer starts to spray when pumping or spraying will not stop spraying when shut off handle released	Shut off lock is engaged	Squeeze shut-off handle and rotate handle away from sprayer tip to disengage handle lock.
Sprayer leaks at closure.	1. Entrapment of foreign particles on surface gasket or O-ring. 2. Cracked bonnet, swollen or defective pump gasket.	1. Clean all foreign particles from pump gasket and O-ring. 2. Remove old gasket and replace with new one.
Sprayer material overflows through pump barrel or pump handle nose when handle is unlocked.	Sediment or foreign particles under check valve or trapped from the nozzle pump check valve.	Depressurize tank. Remove pump assembly, clean check valve and pump valve seat. Replace if necessary.
Hose leaks at tank.	1. Loose hose nut 2. Cracked hose	1. Tighten hose nut 2. Replace hose assembly
Hose leaks at shutoff.	Swollen, slit or faulty O-ring.	Replace hose assembly
Noze sprays pattern, partial spray or complete stoppage	Severe extension nozzle, filter (if equipped), or shut off engaged.	1. Remove nozzle and clean. 2. Remove extension and clean. 3. Clean filter. Unscrew shut off body from hose adapter. Remove filter from hose adapter and clean. Snap filter back on hose adapter and reassemble shut off. 4. Depressurize tank. Remove lever and unscrew retainer from shut-off. Remove rubber diaphragm and clean inside of shut-off. See Shut-Off Assembly Instructions.
Sprayer is difficult to pump	1. Damaged or worn plunger O-ring 2. Plunger ring dry.	1. Replace with new plunger O-ring. 2. Oil plunger ring.
Outlet tube leaks.	When sprayer shut-off valve is opened, tank air pressure is released (probably nozzle before tank is empty)	Replace removable plastic outlet tube.
Sprayer tank leaks.	Feed-in of spray material escaping from tank.	Replace tank
Nozzle drips when nozzle control valve is shut off.	Not making cut valve or worn cut diaphragm	1. Depressurize tank. Remove lever and unscrew retainer from shut-off. Remove rubber diaphragm and clean inside of shut-off. 2. Replace diaphragm if swollen or torn. Replace vent off spring if broken. See Shut-Off Assembly Instructions.

If you have any problems with, or have any questions about your sprayer **BEFORE YOU RETURN IT TO THE STORE, CALL OUR TOLL FREE CUSTOMER SERVICE CENTER AT:**

1-800-3 11-9903